

TEILE

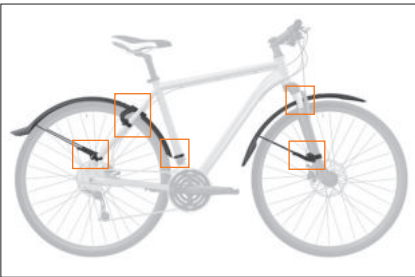

1. RADSCHUTZMONTAGE VORNE

1.1 VORBEREITUNG: MONTAGE GUMMI-EINLAGEN

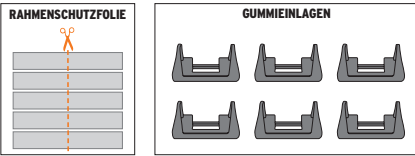
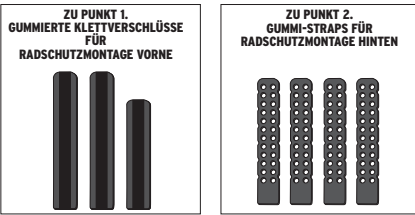
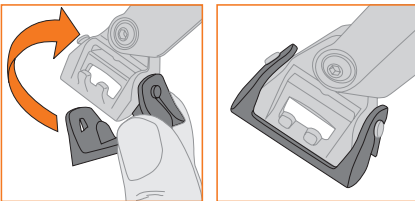

1.2

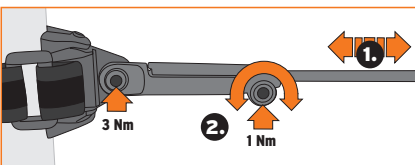
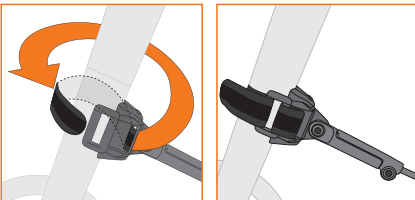

2. RADSCHUTZMONTAGE HINTEN



2.1 VORBEREITUNG: MONTAGE GUMMI-EINLAGEN

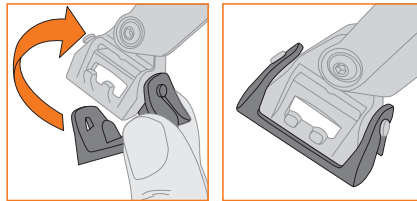

2.3

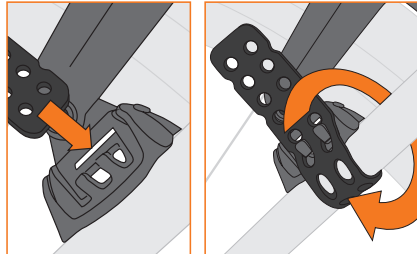

2.4

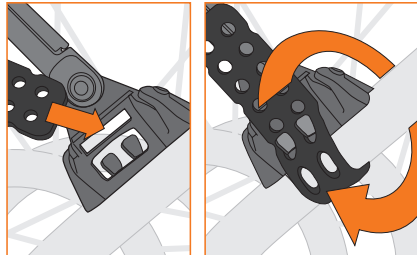

3. GGF. STREBEN KÜRZEN

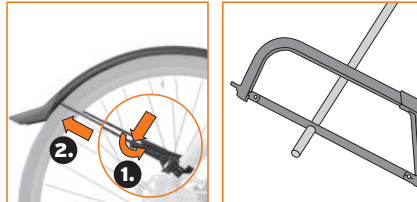

OPTIONAL

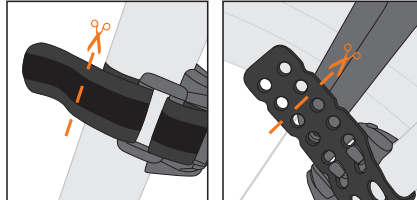

ACHTUNG!
15 MM MINDESTABSTAND ZWISCHEN PROFIL UND REIFEN EINHALTEN.

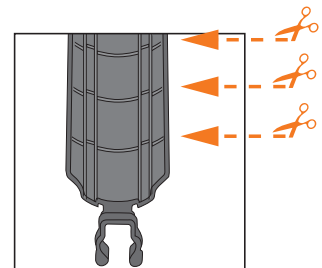
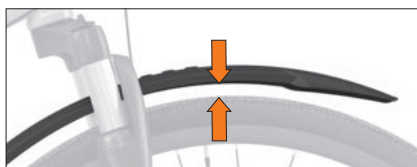

KÜRZUNGSMÖGLICHKEITEN *

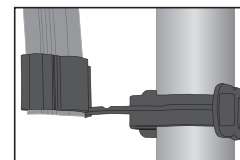

RAHMENCLIP *

* NUR BEI VELO 65 MODELLEN MÖGLICH